

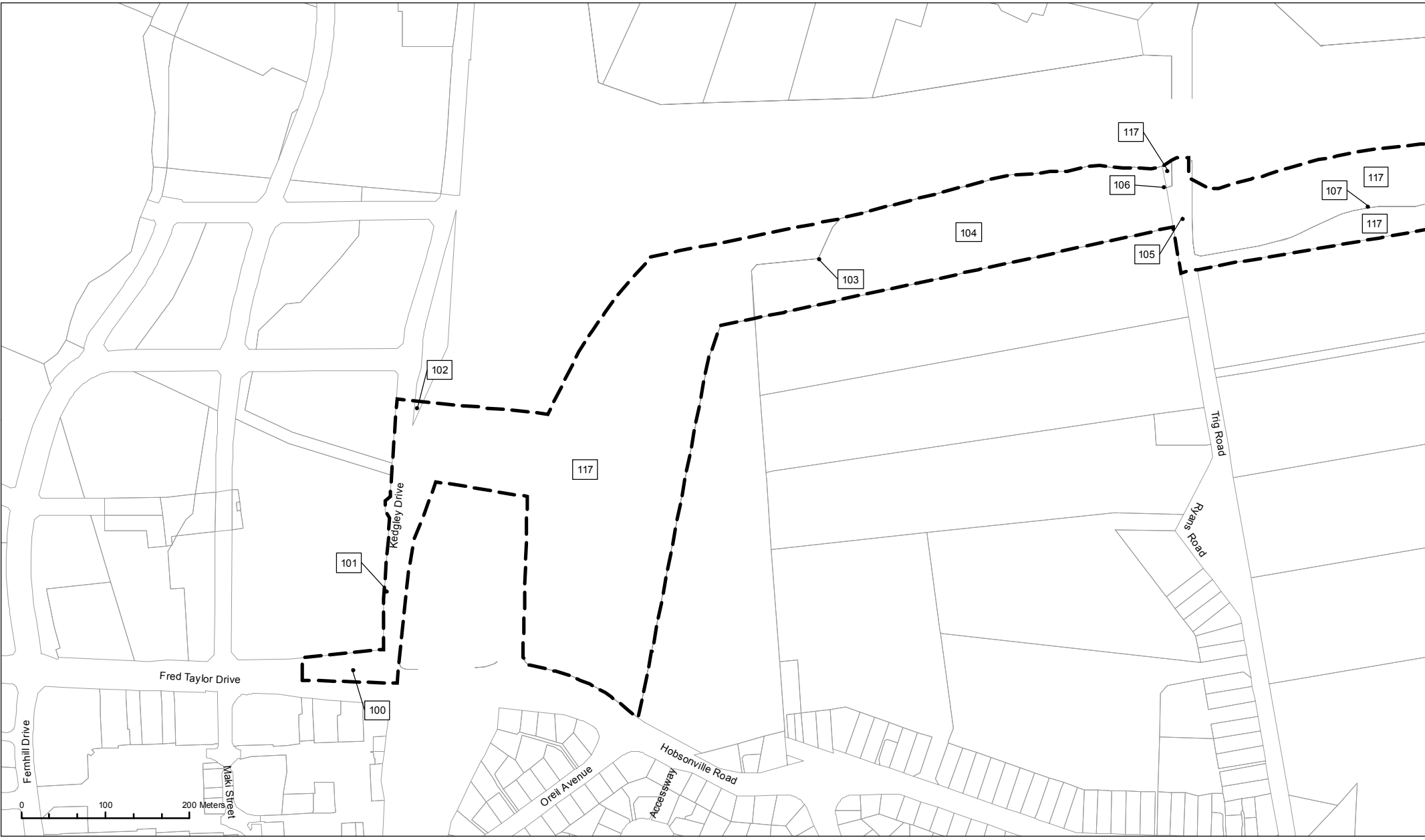

I:\AEN\Projects\A4E\4521\_North Harbour Watermain\_Nc2\05\_Technical\Spatial\MAXDLRPNOR3.mxd



**Key**

 Proposed Designation

Map contains information sourced from LINZ.  
Crown Copyright Reserved.

## North Harbour 2 Watermain

Designation of Land for Water Supply and Wastewater Infrastructure Purposes

**NOR 3 - Map 1 of 4**

Map Scale @ A4 - 1:6,000

Date: 6/04/2016

**Watercare** 

An Auckland Council Organisation

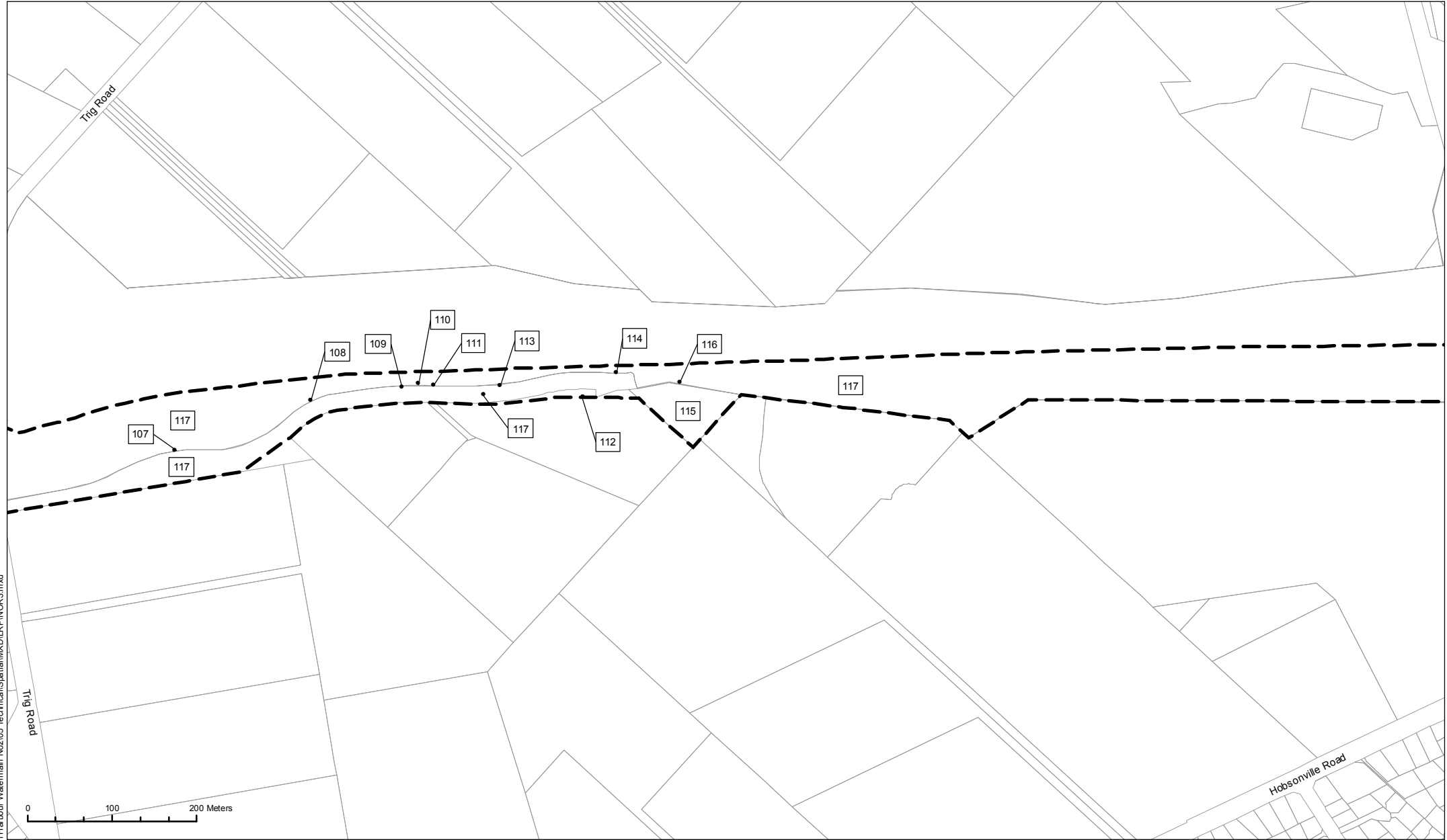

I:\AEN\Projects\A4E\4521\_North\_Harbour\_Watermain\_N02\05\_Technical\Spatial\MXD\LFP\NOR3.mxd

**Key**

 Proposed Designation

Map contains information sourced from LINZ.  
Crown Copyright Reserved.

## North Harbour 2 Watermain

Designation of Land for Water Supply and Wastewater  
Infrastructure Purposes

**NOR 3 - Map 2 of 4**

Map Scale @ A4 - 1:6,000

Date: 6/04/2016

**Watercare** 

An Auckland Council Organisation

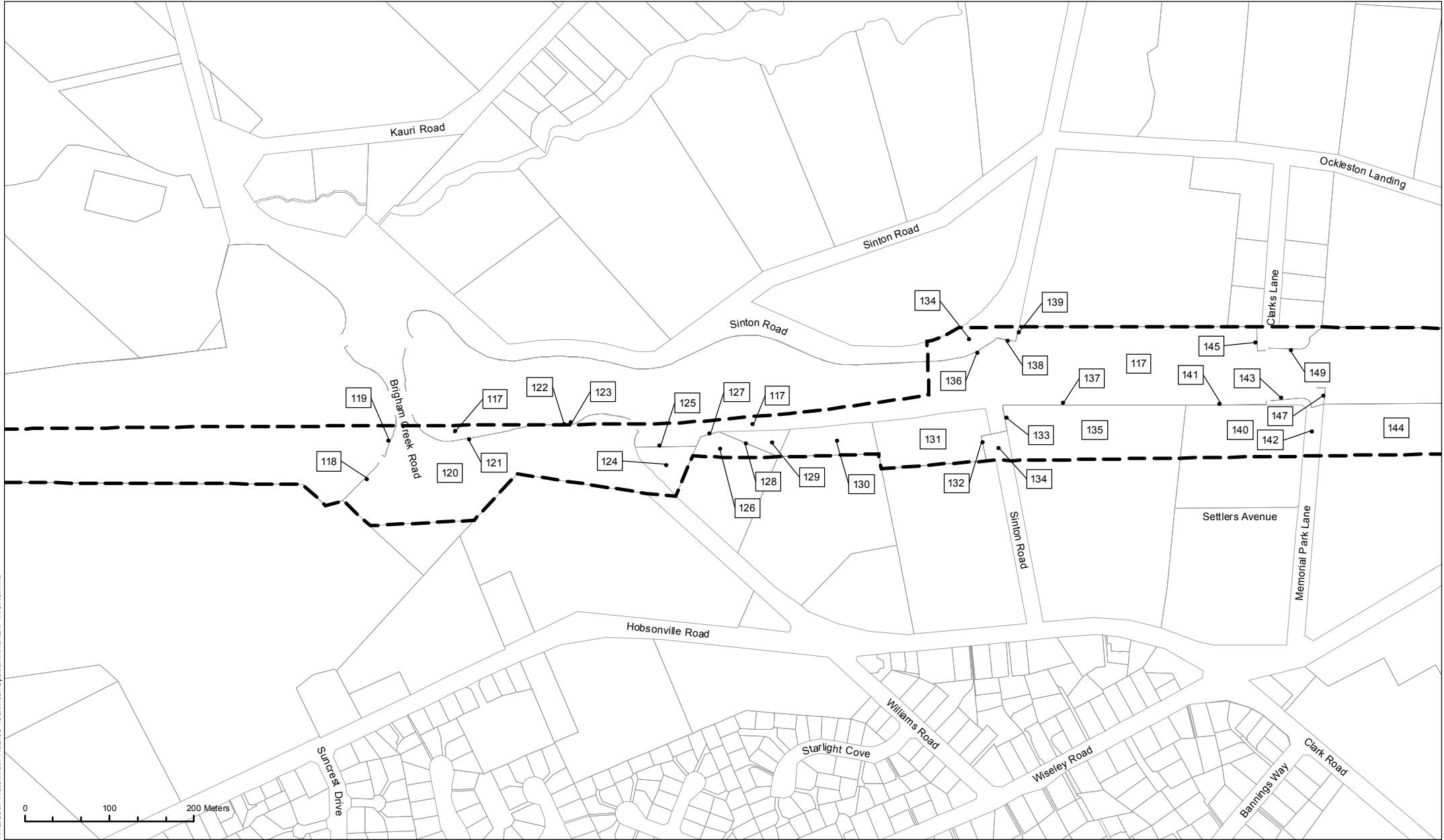

I:\AEN\Projects\AEC\4521\_North\_Harbour\_Watermain\_Nc2\05\_Technical\Spatial\MKD\LRPNOR3.mxd

**Key**

 Proposed Designation

Map contains information sourced from LINZ.  
Crown Copyright Reserved.

## North Harbour 2 Watermain

Designation of Land for Water Supply and Wastewater Infrastructure Purposes

**NOR 3 - Map 3 of 4**

Date: 6/04/2016

**Watercare** 

An Auckland Council Organisation

I:\AEN\PA\Projects\A404521\_North Harbour Watermain\_N02\05\_Technical\Spatial\MKDLRPNOR3\_sheet4.mxd

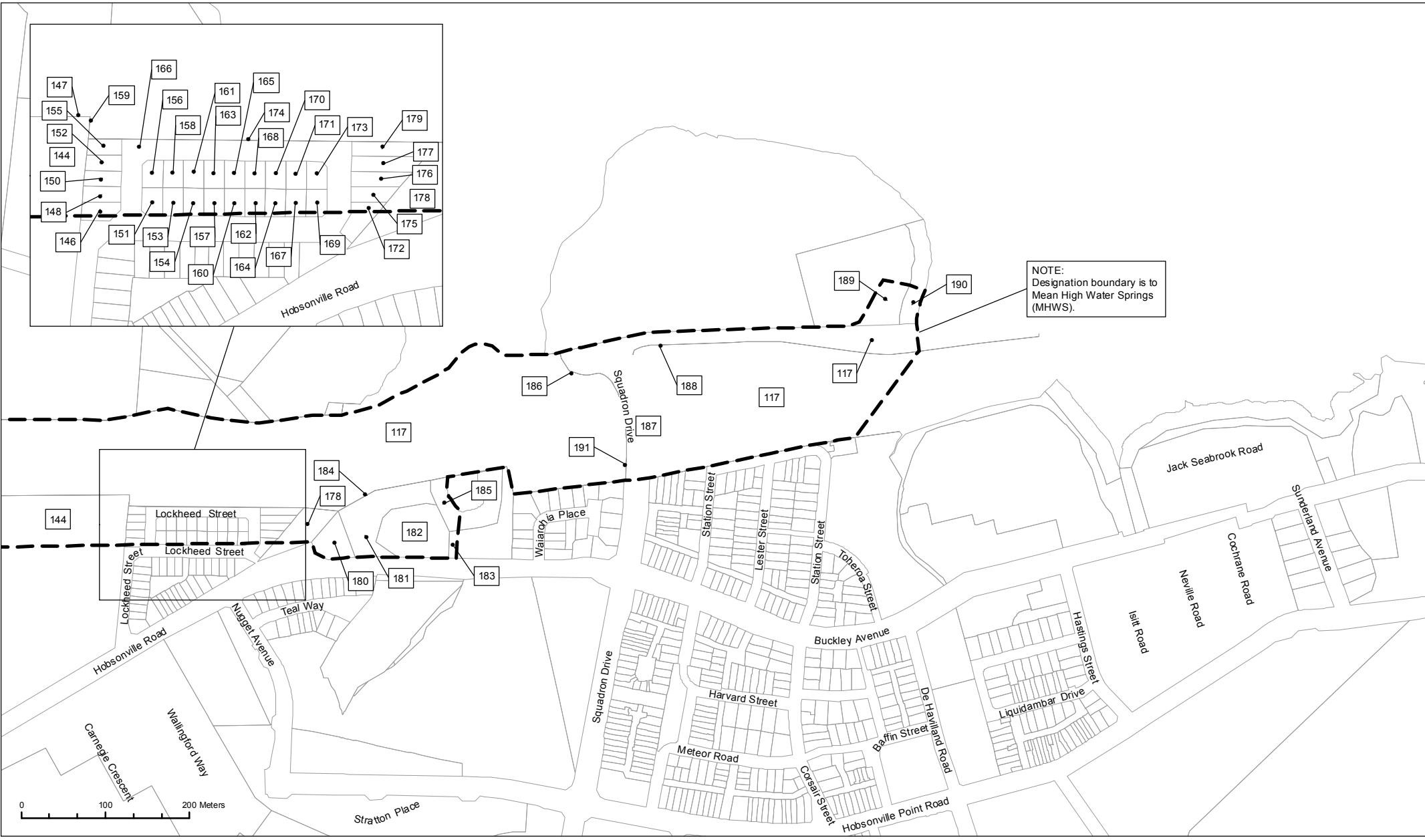

NOTE:  
Designation boundary is to  
Mean High Water Springs  
(MHWS).

**Key**  
 Proposed Designation

Map contains information sourced from LINZ.  
Crown Copyright Reserved.

Map Scale @ A4 - 1:6,000

## North Harbour 2 Watermain

Designation of Land for Water Supply and Wastewater  
Infrastructure Purposes

**NOR 3 - Map 4 of 4**

Date: 6/04/2016



**SCHEDULE OF LAND INCLUDED IN THE DESIGNATION**

Map ID	Appellation / Road Name	Certificate of Title	Owner (Mar 2016)
100	Fred Taylor Drive		Auckland Transport
101	Kedgley Drive		Auckland Transport
102	Sec 44 SO 430649	587009   642492 (Fee Simple Title.)	Kedgley Investments Limited   Westgate Town Centre Limited
103	Sec 8 SO 445955	570605 (Functioning Indirectly of a Road (Segregation Strip).)	Her Majesty the Queen
104	Sec 7 SO 445955	570610 (Severance.)	Her Majesty the Queen
105	Trig Road		Auckland Transport
106	Sec 44 SO 447691	579743 (Road Stopped and Set Apart for the Functioning Indirectly of a Road (Segregation Strip))	Her Majesty the Queen
107	Sec 46 SO 447691	579742 (Land Set Apart for the Functioning Indirectly of a Road (Segregation Strip))	Her Majesty The Queen
108	Sec 47 SO 447691	586444 (Functioning Indirectly of a Road (Segregation Strip).)	Her Majesty the Queen
109	Sec 48 SO 447691	586444 (Functioning Indirectly of a Road (Segregation Strip).)	Her Majesty the Queen
110	Sec 49 SO 447691	579742 (Land Set Apart for the Functioning Indirectly of a Road (Segregation Strip))	Her Majesty The Queen
111	Sec 50 SO 447691	586444 (Functioning Indirectly of a Road (Segregation Strip).)	Her Majesty the Queen
112	Sec 29 SO 447691	580795 (Severance Taken)	Cameron Alan Ward
113	Sec 51 SO 447691	579742 (Land Set Apart for the Functioning Indirectly of a Road (Segregation Strip))	Her Majesty The Queen
114	Sec 52 SO 447691	579742 (Land Set Apart for the Functioning Indirectly of a Road (Segregation Strip))	Her Majesty The Queen
115	Sec 28 SO 447691	580792 (Severance Taken   Amending Notice.)	Watercare Services Limited
116	Sec 53 SO 447691	579742 (Land Set Apart for the Functioning Indirectly of a Road (Segregation Strip))	Her Majesty The Queen
117	SH18		Her Majesty The Queen
118	Sec 58 SO 444423	569730 (Functioning Indirectly of a Road (Segregation Strip).)	Her Majesty The Queen
119	Sec 57 SO 444423	569730 (Functioning Indirectly of a Road (Segregation Strip).)	Her Majesty The Queen
120	Brigham Creek Road		Auckland Transport
121	Sec 54 SO 444423	569730 (Functioning Indirectly of a Road (Segregation Strip).)	Her Majesty The Queen

122	Sec 46 SO 444423	570015 (Functioning Indirectly of a Road (Segregation Strip).)	Her Majesty the Queen
123	Sec 39 SO 444423	568879 (Road Stopped and Set Apart for the Functioning Indirectly of a Road (Segregation Strip).)	Her Majesty the Queen
124	Sec 36 SO 444423	569852 (Severance.)	Her Majesty the Queen
125	Sec 34 SO 444423	569730 (Functioning Indirectly of a Road (Segregation Strip).)	Her Majesty The Queen
126	Sec 32 SO 444423	569513 (Fee Simple Title.)	Joyland International Limited
127	Sec 31 SO 444423	569512 (Functioning Indirectly of a Road (Segregation Strip).)	Her Majesty the Queen
128	Sec 29 SO 444423	569730 (Functioning Indirectly of a Road (Segregation Strip).)	Her Majesty The Queen
129	Sec 66 SO 444423	588085 (Fee Simple Title.)	Her Majesty the Queen
130	Sec 65 SO 444423	568872 (Functioning Indirectly of a Road.)	Her Majesty the Queen
131	Sec 64 SO 444423	570035 (Functioning Indirectly of a Road.)	Her Majesty the Queen
132	Sec 19 SO 444423	570034 (Functioning Indirectly of a Road (Segregation Strip).)	Her Majesty the Queen
133	Sec 14 SO 444423	568879 (Road Stopped and Set Apart for the Functioning Indirectly of a Road (Segregation Strip).)	Her Majesty the Queen
134	Sinton Road		Auckland Transport
135	Lot 2 DP 57408	NA12C/162	Viscount Investment Corporation Limited
136	Sec 11 SO 444423	569730 (Functioning Indirectly of a Road (Segregation Strip).)	Her Majesty The Queen
137	Sec 8 SO 444423	569730 (Functioning Indirectly of a Road (Segregation Strip).)	Her Majesty The Queen
138	Sec 10 SO 444423	568879 (Road Stopped and Set Apart for the Functioning Indirectly of a Road (Segregation Strip).)	Her Majesty the Queen
139	Sec 6 SO 444423	569730 (Functioning Indirectly of a Road (Segregation Strip).)	Her Majesty The Queen
140	Lot 2 DP 475266	654428	Hobsonville Lot 2 Limited
141	Sec 5 SO 444423	568879 (Road Stopped and Set Apart for the Functioning Indirectly of a Road (Segregation Strip).)	Her Majesty the Queen
142	Memorial Park Lane		Auckland Transport
143	Sec 4 SO 444423	568879 (Road Stopped and Set Apart for the Functioning Indirectly of a Road (Segregation Strip).)	Her Majesty the Queen
144	Pt Allot 523 PSH OF Waipareira	(Recreation Reserve)	Auckland Council
145	Sec 1 SO 444423	568879 (Road Stopped and Set Apart for the Functioning Indirectly of a Road (Segregation Strip).)	Her Majesty the Queen

146	Lot 32 DP 484815	687707	Jiangbo Tai
147	Sec 4 SO 445478	575845 (Functioning Indirectly of a Road (Segregation Strip).)	Her Majesty the Queen
148	Lot 33 DP 484815	687708	Hua Jiang
149	Sec 2 SO 444423	568879 (Road Stopped and Set Apart for the Functioning Indirectly of a Road (Segregation Strip).)	Her Majesty the Queen
150	Lot 34 DP 484815	687709	New Zealand Housing Foundation
151	Lot 54 DP 484815	687729	Rongtian Luo
152	Lot 35 DP 484815	687710	New Zealand Housing Foundation
153	Lot 53 DP 484815	687728	Xueying He
154	Lot 52 DP 484815	687727	Yurong Yan
155	Lot 36 DP 484815	687711	New Zealand Housing Foundation
156	Lot 37 DP 484815	687712	D J Homes Limited
157	Lot 51 DP 484815	687726	Xinyin Zhang
158	Lot 38 DP 484815	687713	Yao Dong , Ping Li
159	Sec 32 SO 445478	575845 (Functioning Indirectly of a Road (Segregation Strip).)	Her Majesty the Queen
160	Lot 50 DP 484815	687725	Meng Xia
161	Lot 39 DP 484815	687714	Rui Liu
162	Lot 49 DP 484815	687724	Zhao Liu
163	Lot 40 DP 484815	687715	Welbro Land Development Group Limited
164	Lot 48 DP 484815	687723	Meidi Wang
165	Lot 41 DP 484815	687716	Shujin Li
166	Lockheed Street		Auckland Transport
167	Lot 47 DP 484815	687722	Heqin Qiu
168	Lot 42 DP 484815	687717	Sijia Zhou
169	Lot 46 DP 484815	687721	Kevin & Arwen Co. Limited
170	Lot 43 DP 484815	687718	Qian Wang , Guanglai Ren
171	Lot 44 DP 484815	687719	Ling Meng
172	Lot 59 DP 484815	687734	RZ Investment Limited
173	Lot 45 DP 484815	687720	Ren Liu , Xilin Zhu
174	Sec 9 SO 445478	575845 (Functioning Indirectly of a Road (Segregation Strip).)	Her Majesty the Queen
175	Lot 58 DP 484815	687733	Danfeng Lu
176	Lot 57 DP 484815	687732	Jing Li , Sangyu Zong
177	Lot 56 DP 484815	687731	Kingsdon Investment Limited
178	Sec 1 SO 450384	578612 (Land set apart for Sub Station Purposes)	Vector Limited
179	Lot 55 DP 484815	687730	Mingfang Huang
180	Lot 3 DP 211237	697760 (Land Set Apart for State Housing Purposes)	Her Majesty the Queen
181	Pt Lot 2 DP 330629	697760 (State Housing Purposes)	Her Majesty the Queen
182	Sec 1 SO 419259	507191 (Sewage Purposes)	Watercare Services Limited
183	Lot 102 DP 463135	614582	Her Majesty the Queen
184	Sec 19 SO 445478	574945 (Road Stopped and to be set apart for the functioning indirectly of a road (segregation strip))	Her majesty The Queen
185	Lot 1 DP 330629	125867 (Vesting on Deposit for Local Purpose Reserve)	Auckland Council
186	Sec 33 SO 445478	574945 (Road Stopped and to be set apart for the functioning indirectly of a road (segregation strip))	Her majesty The Queen

187	Squadron Drive		Auckland Transport
188	Sec 27 SO 445478	574945 (Road Stopped and to be set apart for the functioning indirectly of a road (segregation strip))	Her majesty The Queen
189	Lot 1 DP 475066	654401	Ann Kathleen Evans , Michael Ronald Evans
190	Lot 3 DP 475066	654403 (Vesting on Deposit for Local Purpose Reserve)	Auckland Council
191	Sec 23 SO 445478	for the functioning indirectly of a road (segregation strip)	Her majesty The Queen